

Read through - no connection.

MARRIAGE REGISTER
Sandy Creek
Oswego Co., N. Y.
J. Hadley

"Just 100 years ago, Rev. Jacob Hadley entered the first marriage solemnized by him in a little book made by his own hands. It has a faded blue paper cover, the inside pages, which were once pure white, are now slightly yellowed with time, and the whole is held together by a heavy thread doubled and sewn through the sheets.

"On the first white page is the (above) inscription in ink, nicely shaded and spaced on the page, as if the hand that designed it wished to add to the dignity and beauty of the messages which it was destined to contain.

"Below this there was a design made with a flourish, and this design appears with variations at the bottom of nearly every page..." Sketches, October 20, 1927

"...The entries are neatly written in ink, one to a page, and all follow the same form..." Sketches, May 19, 1932

"This little book is now the property of Mrs. Nellie Hadley Scott, the granddaughter of the Rev. Jacob Hadley."
(1927)

Re-transcribed May 31, 1978 by Marie K. Parsons, from Vol. 6 No. 22, Dec. 1962 YESTERYEARS, in which it appeared under the title, 'Marriage Records of Sandy Creek, N. Y. 1827-68 Oswego County.' Courtesy of Louise W. Lynch, Chula Vista, Calif., with annotations and corrections from, "Sketches," a column in The Sandy Creek News, in which the Marriage Register was transcribed May to September, 1932.

Whereabouts of the original book is unknown as of this date. ("Sketches," does not quote each entry exactly. Lynch seems to have corrected the spelling and grammar. The older transcription updates the spelling of surnames, but was done with a familiarity with local families which Lynch does not seem to have.)

No. 2730
Duncan, Rose Expires _____

DO NOT WRITE ABOVE THIS LINE

I apply for the right to use the Library, and agree to comply with all its rules and regulations, and to give immediate notice of any change of address.

Doten Partners

Sign Full Name Rose DUNCAN

Home Address 409 ELM ST

SYRACUSE, NY Phone 423-9079

Business Address _____ Phone _____

GAYLORD 125

PRINTED IN U. S. A.

387-5209
Margaret Narelda
Sebrano

Mario

387-3920

387-⁶⁴⁰⁷~~6467~~

Sandy Creek News & Times

Reel 1	Times	1862-1864	Scattered Issues	
	News	1871-1884	" "	
2	"	1-8-1885	60	12-31-1885
		1-7-86		12-30-86
		1-28-87		12-29-87
3	"	1-5-88		12-27-88
		1-3-89		12-26-89
		1-2-1890		12-25-1890
4	"	1-1-91		1-24-91
		1-7-92		12-29-92
		1-5-93		12-28-93
5	"	1-4-94		12-27-94
		1-3-95		12-26-95
		1-2-96		12-31-96 (Not read)
6	"	1-1-97		12-30-97
		1-6-98		12-29-98
		1-12-99		12-28-99
7	"	1-4-1900		12-27-1900
		1-3-01		12-26-01
		1-2-02		12-25-02
8	"	1-1-03		12-31-03
		1-4-04		12-29-04
		1-5-05		12-27-05
9	"	1-4-06		12-27-06
		1-3-07		12-26-07
		1-2-08		12-31-08

to Reel 40 Mar 4 1985 End of Run

Also have: T. of Sandy Creek

Minute Book 1825-68

Road Comm. 1825-69

Road Dist. 1846-1896

S.C. + Boylston 1895 census

Sketches

Methodist Ch. Rec.

neg

George Hunt and
Marie Parsons Hist.

13 B. P. 2nd row half way Flag

big stone Charles H. Porter by low stone fence on rd, middle
Chester "

126 VR E of J no stone Behind Marbigo ^{see} GE
140 Hwy 1

1 Charles E Blodgett see HF N near sled

RT 15 E through Lucas R on exit onto RT 22

RT 14 Noyes cam on L big monument

RT 22 Orwell RD

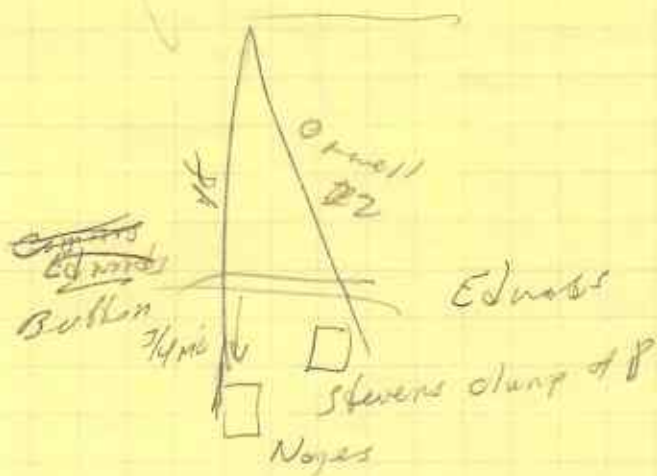

~~Map with office etc May~~

Sandy Creek NY Tapes

11-15-89

Reel 1A

Reading tombstone inscriptions	000 - 060
Notes in car Mon ^{evg} 9-25-89	060 - 116
Reading Town Records first time 9-26-89	Deaths 116 - 456
"	Births 456 - 517
"	Marriages 517 - 632 (end)

1B

"	"	"	000 - 104
Town Records of Sandy Creek (miscellaneous)			104 - 125
Sandy Creek News			125 - 214
Wednesday morning in car			214 - 234
At Hayes Cemetery - Edgar Rogers death			234 - 243
Sandy Creek News			243 - 321
Thursday morning 9-28-89 at Town Hall			321 - 325
(Ended short because need to redo town records)			

Reel 2A

Second reading of Town Records 9-28-89	Deaths 000 - 429
	Marriages 429 - 633 (end)

2B

"	"	Marriages (cont.) 000 - 113
"	"	Births 113 - 278
Sandy Creek News		278 - 513
"	Fri day 29 Sep 1989	513 - 638 (end)
"	"	000 - 240
Saturday Morning 30 Sep 1989. Fris. 60 Syracuse		240 - 249
Sandy Creek News 30 Sep 1989		249 - 384
Comment in car Sun 1 Oct 1989		384 - 391
Sandy Creek News "		391 - 638 (end)

Reel 3A

"	"	"	"	000 - 266
Monday 2 Oct 1989	Comments on (circa) Sackett's Harbor			266 - 283
Sandy Creek News 2 Oct 1989				283 - 345 (end)

T. L. Sandy Crk Micro Book 1825-68 }
 Road Comm Bk 1825-69 } No use
 Road Dist Book 1846-96 }
 Rose Dunson
 1-423-9079
 Porter Research

1845 SC & Baylison Census - Enclosed some very difficult to follow.

Reel 1
 { Sandy Creek Times Dec 27, 1862 - Jan 3, 1863, Southern Issues
 { Sandy Creek News May 6, 1871 - Jan 31, 1884, Southern Issues
 - Copied 2 letter items on tape, incl Rhode Porter's death.

9.27.89

In Vol II of Sandy Creek Times, found Seth Porter obit. No entries

From "Sketches"

~~1822~~, copy ~~18~~, ~~24~~, ~~30~~, ~~36~~, ~~41~~, ~~30~~, ~~18~~, ~~18~~, 320, ~~20~~, ~~11~~, ~~29~~, ~~28~~
 152, 222, 235, 340, 351
 81, 94, 95, 97, 20, 130, 21, 29, 7

Myra Hadley married a Smith? Hadleys from VT - early settlers
 9-28-89

Retyped Birth, Marriage, Death books at Town Hall.

Checked Marriage Register, Sandy Creek, Orange, NY, ^{of} J. Hadley - No entries

Reel 9 Sandy Creek News
 Thurs Jan 28 1906 V.R. Porter news item typed
 Jul 5 " " ^{notice}

No Death notice	Reel 2	THURS	Apr 23, 1885	"Town & Vicinity"	"Ridge Rd"	Seth Porter d.
set obituary →	"	"	Apr 30, 1885	"	"	Mrs. Sarah Bayne
	"	"	May 11, 1885	"	"	"
	"	"	Jan 11, 1885	"Sandy Creek News"	"	Vr. Porter
	"	"	July 2, 1885	"	"	Charles Porter
	"	"	Aug 20 "	"	"	Dr. White, Dr. Pate
	"	"	Aug 27 "	"	"	Mrs. C.
	"	"	Sep 10 "	"	"	Harry Porter
	"	"	Oct 16 "	"	"	"
	"	"	Oct 22 "	"	"	V.R., B.B., G.S. Porter
	"	"	Dec 3 "	"	"	B.O. Dolan
	"	"	10 "	"	"	Porter

Ada Parker 2 Feb 1811 d.

Rhoda Parker 25 Jan 1689 86 Geo 13 dx

Edgar S. James & Mary Rogers d. 1 Dec 1834 26 Geo

Seth Parker Sun 19 Apr 1845 in 93rd yr.

Stevens Cam has Abbel & Levi, their wives, and children.

Also has Benj & Ely Grey

Does not have Seth, Rhoda, v.R., Mary Parker; nor Luther & Anne Grey.

Grave Locations needed

7-9-88 Lucethia Parker ✓

6-9-1900 Ozzie R

6-16 1903 Jrs

Seth Parker

Rhoda Parker

Van Rensselaer Parker

Eliza Parker

Mary Parker

Florence A. Parker

Ada Parker

Lillie/Lilla Parker

Delos Parker

Samuel Rogers

Rachel Rogers

Luther Grey

Anne Grey

Manuscripts

Baker, Peter, Smith, Vredenburg - No Rogers, Coney - No Luck
Copied some Baker info on speculation

- No conⁿ R 949.2 B17 Appleton, Wm. Ancestor of Priscilla Baker who lived 1674-1731
& was wife of Isaac Appleton of Ipswich. Comb, MA 1870
- No conⁿ " B17a Baker, E. Genealogy of Eber & Lydia Smith Baker of America, Ohio
and their descendants Brooklyn, NY 1809
- N.S. no conⁿ B17b Baker John Milnes. The Baker Family and the Edger Family,
of Roxbury, NJ & NY City. Trumbull 1970
- " B17c Baker, N.M. Genealogy of the descendants of Edward Baker
of Lynn, MA Syracuse, 1967
- No conⁿ " B17d Baker, Smith. Genealogy of the Family of Deacon Smith
Baker of Lubekfield, ME 1874 Lowell, MA 1874
- Cont conⁿ " B17e Clark, Bertha W. Descendants of Francis Baker of
Yarmouth Author, 1951
- Cont conⁿ " B17f Edmunds, Elizabeth A. Journey - -
- No conⁿ " J68 p 161-65 in Tallies sum
- Good conⁿ " B17g Parsons, Geroldine Jane. The Baker Fam. v. 1.
- " B17h Senenson, E.D. Simon Baker and his desc. Salt Lake 1969
- " T3762 Thompson W.B. Thompson lineage of mention of
allied families Harrisburg, PA c 194

Ms. Cyril M. Edmunds R.V.I. Lee Center, NY 13363 29 Oct 1973

- 929.2 56 86 Dwight's History of the Strong Family. Ranj J. Dwight
Gateway Baltimore, 1971
- 929.2 195 Notes on the Vredenburg and Burnett Families
No index, prob. no conⁿ. The Knickerbocker Press, NY, 1917
- 929.2 R63 Rogers, Rev Charles, D.D., LL.D. Four Yorkshire Families:
Roger, Plym, Constable and Haldene of Bermsay
Remote interest, conⁿ correct Edinburgh: Private, 1887

Look up Mary Casswell in sketches

Where are Seth & Rhoda buried?

Any evidence linking Seth to Lewis & Ashbel Sr; Ashbel Sr?
Birth date & place?

Where are Seth's children buried?

Any links from Phoebe Baker to Thomas Baker, Sr?
Phoebe was also the sister of Thomas Baker (Sr.).

Was Thomas Baker's wife Mary Casswell?

Who were Mary (Smith) Rogers' relatives?

John Admin 22 Jul 1861
John W, 30 Jul 1880
Lucretia July 9, 1898
Eugene Jan 23 1900
Orlo Jun 9 1900
Urie Jul 11 1900

NY State Archives
518/494-1985

From DAB List

Porter Bernice died (buried)	25 Jul 1892	20	75 yr	7mo
Carol H. "	16 Dec 1892	22	5 yr	
Emma Jane	22 Feb 1914	62)	6mo, 8 dz	
Mary Ann	31 Aug 1906	Age	85	
Minerva	24 Nov 1907		87	
Peri	5 Jul 1907		32	
burial date: Van Rensselaer	29 Jun 1906	20	84	

From Lot Book No 1 Woodlawn Cem. 1. Jain Cem Assoc.

Barney Parker Sec A Lot 38

Burial Grave Interments Location

2134	1	Child of Benson & Porter (Harry)	Aug 1881	(Burial Book 1)
2379	2	Barney Parker (Bernice)	Jul 25 92	75 yr 7mo (Burial Book 1)
2391	3	Carol H. Parker	Dec 16 92	5 yr (")
	4	Minerva Parker N7E4	Nov 24 1907	Age 87
3464	5	Bertie S. Parker North line	Feb 4 1929	Age 94
3531	6	H. Ardell Parker N.N. Cor 8 6 1/2 ft	Died April 29 1930	Age —

Van Rensselaer Parker Sec E Lot 165

8 Line E 1'6" Jun 28 1906 North side

Mrs Mary A Parker on p. 180

Sandy Creek Town Hall

Line 747 V.R. Parker

100 Rose Ann Reynolds 68-27 W Sandy Creek Lynton Baker Elenora Cars
 215 Phoebe D. Rogers 77 72 Head Unit Oak Polly Cars
 414 Lucinda Porter

9-28-29

Questions

10-89

Any vital records "buried" in town minute books?

When and where did Elizabeth Rogers Porter die? (wife of V.R. Porter)

Are Phoebe Baker Rogers and her brother, Thomas, children of the Thomas and Mary Baker who are buried in Noyes cemetery?

Who were the parents of Mary Smith Rogers? Did they move from Jefferson Co. to Sandy Creek?

When did Rhoda Porter's parents, Luther H. Carey and Hans Vredenburg Carey die? Who were their parents?

How did Wm. Constable promote his land sales? What brought groups of families from eastern NY to Sandy Creek rather than to some other place?

Was Thomas Baker Sr.'s wife Mary Caswell?

Map of Roads around Porter property

10-1-29

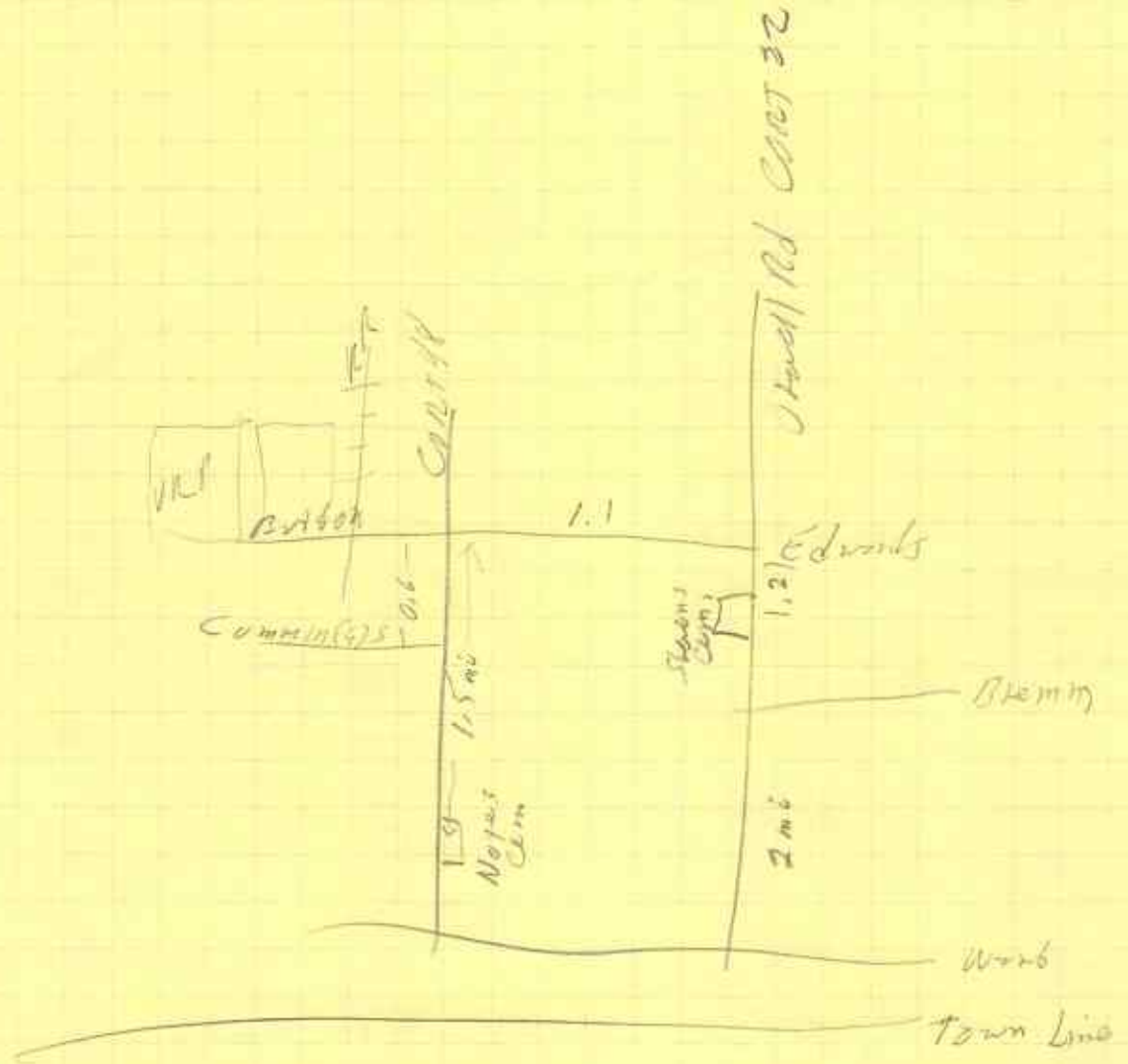

Woodtown Cem Index

PORTER, BARNEY	A-38	I	13
, V. R.	E-165	I	176
, Mrs MARY A	E-227	I	180
, CHARLES H	E-232	I	182
, " "	G-268	I	209
, CHARLIE E	H-319	I	232
, MYRTON O	O-23	I	316
, CLAUDE S (w/ Hattie)	P-17	I	21
, JAMES U	R-22	I	51
, REGGIE	S-46	I	81

